

KeySafe™ Consumer 500
User Guide

Pushbutton combination

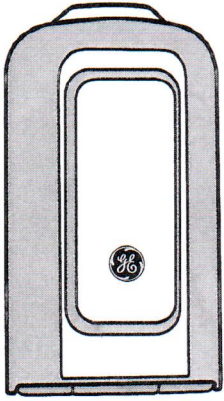

P/N 10102770P1 • July 2010
 Copyright © 2010 GE Security

A

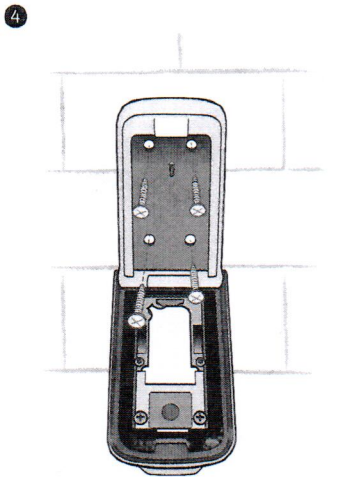
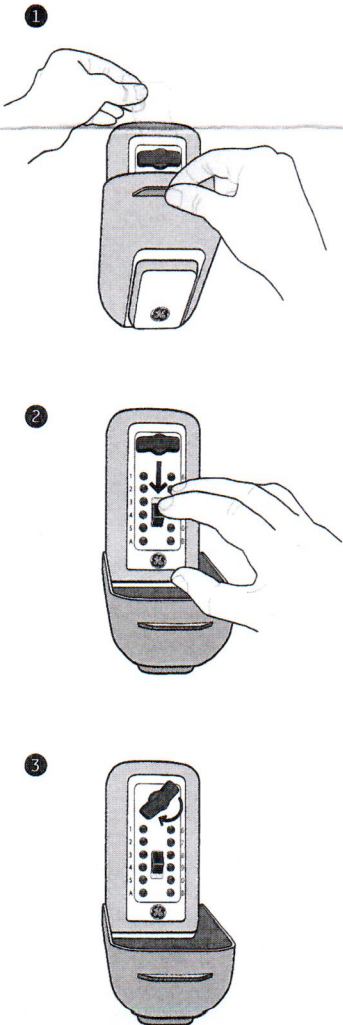

B

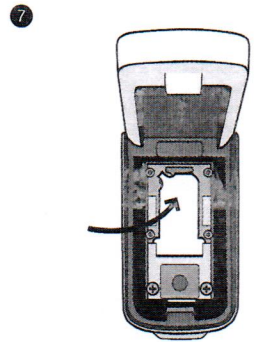
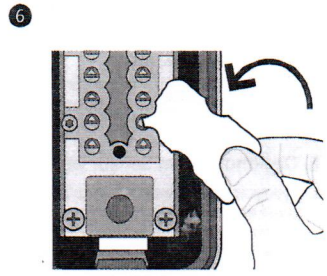
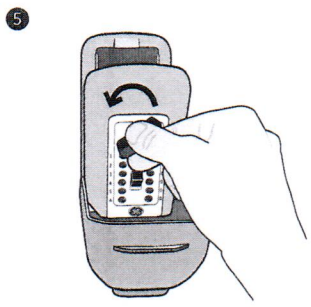
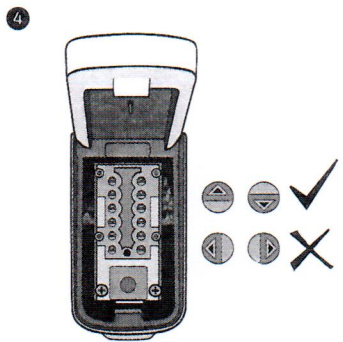
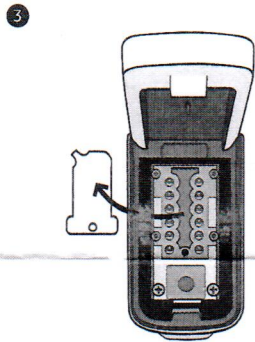

C

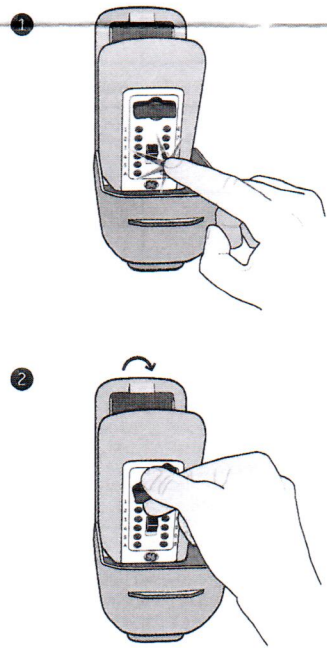

D

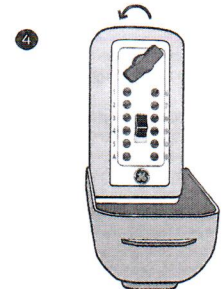
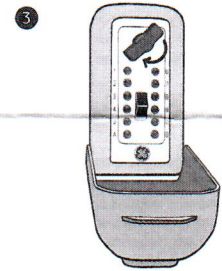
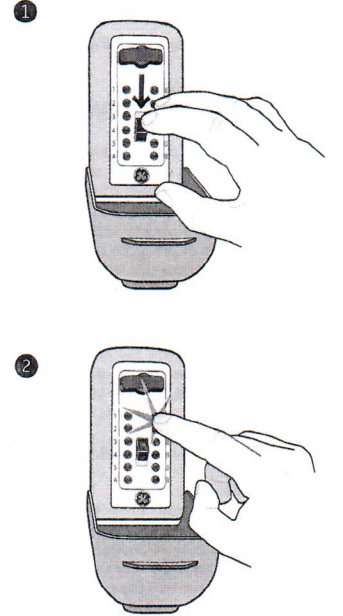

E

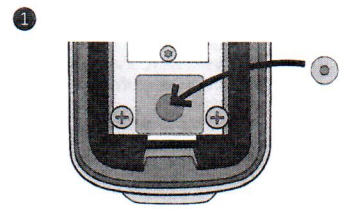

Installation Instructions

See pictures for step-by-step instructions. Further information is provided below.



= Enter the combination.

A. Mounting the KeySafe Consumer 500

1. Hold the clear plastic tab and pull open the weather cover.
2. Press down on the CLEAR button.
3. Turn the OPEN handle clockwise 180° to open the lid.
4. Use the mounting template to position the holes so they are as close to the center of the brick as possible. Do not install screws into mortar since this will weaken the mounting.
5. Use the mounting template to drill four mounting holes using a 5mm masonry drill bit to a depth of at least 7mm deeper than the length of the screw.
6. If using the optional alarm sensor, refer to section E. Optional Alarm Sensor Installation.
7. Clean out dust and debris from all holes.
8. Position the KeySafe on the four holes and drive the screws directly into the brick. **(Note: You must use the included masonry screws or an equivalent to maintain the LPS1175 security certification.)**
9. Tighten the screws until the heads are snug against the back of the KeySafe. Be careful not to over tighten the screws.

Note: Do not mount KeySafe closer than 6" or 15cm to the corner of a masonry surface. Make sure KeySafe is mounted flush with masonry surface and the masonry screws are only installed directly into brick. Never install masonry screws into mortar. Minimize all gaps between back of KeySafe and masonry surface.

B. Setting your combination

- There is no preset combination on your KeySafe Consumer 500. Select your own combination. Each number/letter can only be used once.
 - Do not use a combination that can be easily guessed.
1. Press down on the CLEAR button.
 2. Turn the OPEN handle clockwise 180° to open the lid.
 3. Slide the plastic instruction card on the lid towards the hinge of the KeySafe and remove the card.
 4. There are ten numbered buttons and two lettered buttons with arrows on the back of the lid. Arrows pointing away from the hinge are OFF and are not part of the combination. Arrows pointing towards the hinge are ON and are part of the combination.
 5. With the KeySafe open, turn the open handle counter clockwise 180°, back to the locked position.

Important! The OPEN handle must be in LOCKED position before the code can be changed. Forcing the setting buttons when in the OPEN position may damage the KeySafe and void the warranty.
 7. Use the code change tool on the plastic card to set the combination. To add a number or letter to the code, use the code change tool to push in the grooved arrow by the number/letter you wish to set. Turn 180° until the arrow pops back up completely and the arrow points in the ON direction. To remove a number or letter from the code, use the code change tool to push in the grooved arrow by the number/letter you wish to set. Turn 180° until the arrow pops back up completely and the arrow points in the OFF direction.
 8. Place the plastic card over the back of the lid and slide back into place.

C. Testing your combination

1. Make sure OPEN handle is in the locked position. If not, turn OPEN handle counter-clockwise until it's in the locked position. On the front of the KeySafe, press only the buttons in your combination. Press each button in until it clicks. If you press the wrong button, push down on the clear button and enter your code again.
2. Turn the OPEN handle clockwise 180° to open. If the combination is set correctly, the OPEN handle will turn fully and the locking bolt will retract. If not, push down the CLEAR button and refer to section B. Setting your combination.

D. Opening and Closing your KeySafe

1. Press down on the CLEAR button.
2. Enter the combination. If you enter an incorrect combination, press down on the CLEAR button to reset the buttons and reenter the combination.

3. Turn the OPEN handle clockwise 180° to open. When you turn the handle, the combination will clear. **Note: The open handle is designed so it cannot be forced open. If an incorrect code is entered and the handle is forced, the handle will unlatch from the locking mechanism and turn freely without opening. To reset the handle, turn it all the way back to the locked position where it will snap back into place.**

4. To relock, close the lid and turn the OPEN handle counter-clockwise 180° back to the locked position.

E. Optional Alarm Sensor Installation

1. If you purchased the alarm sensor separately, locate the small, round magnet that came with the sensor. Attach the adhesive sticker to the back of the magnet and then remove the paper from the tape on the back of the magnet and stick the magnet into the hole according to figure E.
2. Use the mounting template to drill a 10mm hole through the wall so the wiring can be routed to the alarm system.
3. Insert alarm sensor wires through the hole so they pass through to the inside of the wall. Carefully push the alarm sensor into the wall until it is flush with the surface of the wall.
4. Connect the sensor to your alarm system per your alarm system instructions. If you are not familiar with your alarm system, we recommend you contact the company that installed your alarm to correctly configure the sensor.
5. Configure your alarm for the sensor and then open and close the KeySafe. Check your alarm system to make sure the sensor is working properly.

Parts Included

KeySafe Consumer 500, 002049 includes:	
Masonry mounting kit	10102698G1
Code change tool	

KeySafe Consumer 500 with Alarm Switch, 002050 includes:	
Alarm switch	10102706G1
Masonry mounting kit	10102698G1
Code change tool	

Accessories/Replacement Parts

Item	Part #
Alarm switch	R1075-N (US) 10102706G1 (Europe)
Weather cover	10102726P1
Code tamper plate	10102703G1
Masonry mounting kit	10102698G1
Key Cover	10102725P1

Limited Warranty

GE Security warrants that this product will be free of defects in material and workmanship for one year (two years in Europe) from the date of purchase. This warranty is limited to repair or replacement at GE Security's option. This warranty does not cover forgotten or incorrectly set combinations. Damage caused by modification, abuse or misuse, wear and tear, improper installation, application, storage, or fault or negligence of a party other than GE Security are not covered. GE Security will not be responsible for labor costs of removal or reinstallation of products. The repaired or replaced product is then warranted under the terms of this limited warranty for the balance of the term of the warranty or for 90 days, whichever is longer. GE SECURITY MAKES NO OTHER WARRANTY, EXPRESS OR IMPLIED, OF MERCHANTABILITY OR FITNESS FOR A PARTICULAR PURPOSE. IN NO EVENT SHALL GE SECURITY BE LIABLE FOR LOSS OF USE, LOST PROFITS, THEFT, PROPERTY DAMAGE, SPECIAL, INCIDENTAL OR CONSEQUENTIAL DAMAGES. To obtain repair or replacement information under the terms of this warranty, please contact your local supplier.



www.gesecurity.com
Europe: www.gesecurity.eu

KeySafe™ Consumer 500

Mounting Template

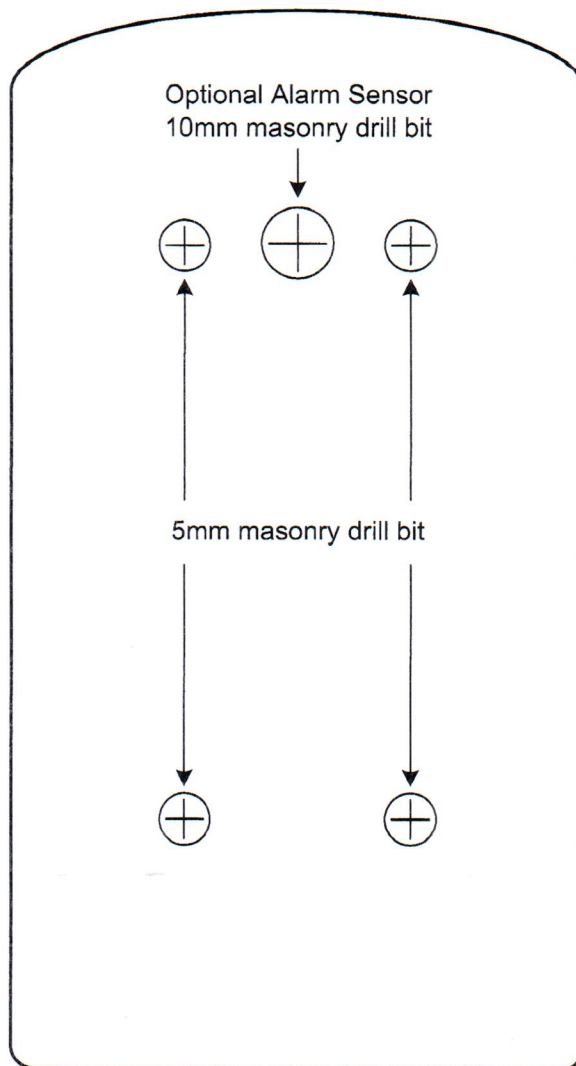

Tools Needed

- Drill
- 5mm masonry drill bit
- Optional – 10 mm masonry drill bit (for alarm sensor installation)
- Torx T30 screwdriver